

FIGURE 2

LEGEND:

⊕ E-2 = GROUNDWATER MONITORING WELL

WMU = WASTE MANAGEMENT UNIT

MONITORING WELLS B-204A, B, AND C ARE COMPLETED AS A CLUSTER IN A SINGLE BOREHOLE. WELL B-204A IS COMPLETED IN THE SS2 SANDSTONE UNIT. WELLS B-204B, AND C ARE COMPLETED IN THE SS1 SANDSTONE UNIT.

MONITORING WELLS E-1A, E-1B, E-1C, AND E-1D ARE COMPLETED AS A CLUSTER IN SEPARATE AND INDIVIDUAL BOREHOLES. EACH WELL MONITORS A SEPARATE SANDSTONE UNIT.

- NOTES:
1. TOPOGRAPHY IS BASED ON AN AERIAL SURVEY PREPARED BY AERIAL PHOTOMAPPING SERVICES (APS) OF CLOVIS, CALIFORNIA BASED ON AN AERIAL PHOTOGRAPH TAKEN BY APS ON JUNE 20, 2002 ON BEHALF OF THE COUNTY OF FRESNO.
 2. MONITORING WELL LOCATIONS* ARE BASED ON SURVEY INFORMATION COMPILED BY THE COUNTY OF FRESNO, CONSTRUCTION DIVISION, SURVEY TEAM AS OF JUNE, 2002. *E-10 WAS SURVEYED IN MAY, 2004 AS IT WAS NEW.
 3. WMU LOCATIONS ARE BASED ON SURVEY INFORMATION COMPILED BY THE COUNTY OF FRESNO, CONSTRUCTION DIVISION, SURVEY TEAM AS OF NOVEMBER 1992.

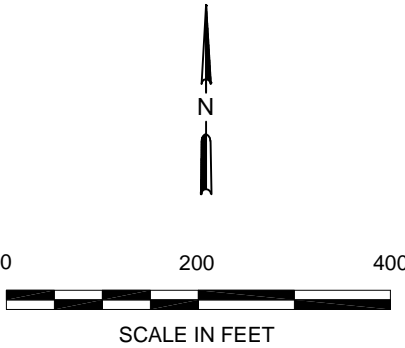
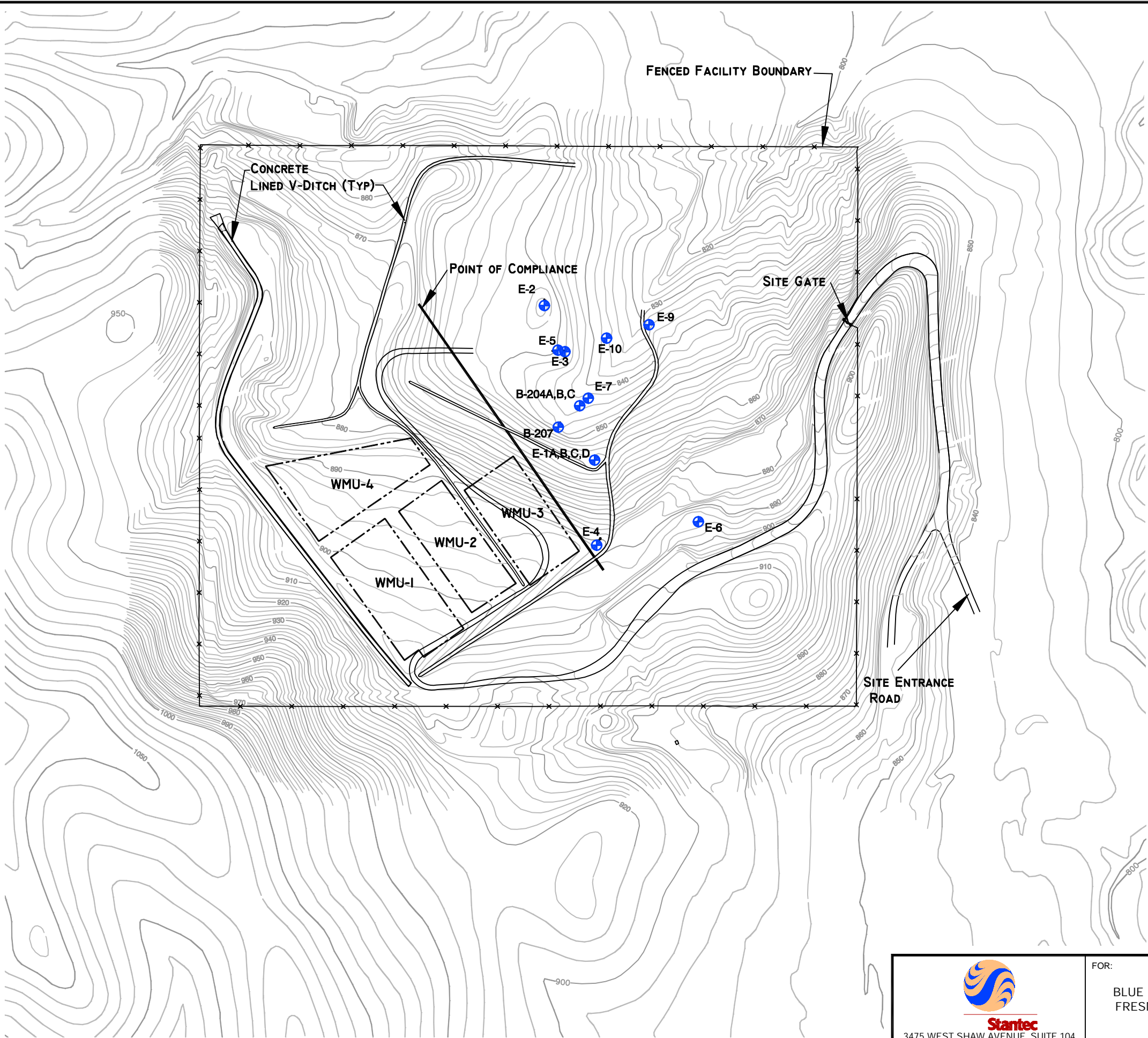

3475 WEST SHAW AVENUE, SUITE 104
FRESNO, CALIFORNIA 93711
PHONE (559) 271-2650/271-5108 (FAX)

FOR:
BLUE HILLS DISPOSAL FACILITY
FRESNO COUNTY, CALIFORNIA

JOB NUMBER:
94OT.03302.00

DRAWN BY:
MDR

CHECKED BY:
FG

APPROVED BY:
--

FIGURE:
2
DATE:
08/26/06

SITE PLAN