

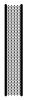

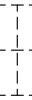

FLOOR PLAN LEGEND	KEYED NOTES
 EXISTING WOOD STUD WALL	1 REMOVE EXISTING CARPET, PAD AND RUBBER WALL BASE. REMOVE ALL EXISTING FLOORING ADHESIVES AND INSTALL ARDEX FLOOR LEVELING COMPOUND WITH FEATHER FINISH. INSTALL NEW CARPET, RUBBER FLOORING, SPORTS RUBBER FLOOR TILE AND RUBBER BASE AS INDICATED AND AS PER MFG'S RECOMMENDATIONS. ALL CARPET SEAMS SHALL BE #99 WATER-BASED SEAM WELDS, CHEMICALLY WELDED.
 FURNITURE & FIXED SHELVING TO BE REMOVED & RESET BY OWNER	2 EXISTING LIBRARY SHELVING AND BUILT-IN CASEWORK TO REMAIN.
 NEW CARPETED AREAS	3 EXISTING LIBRARY SHELVING OR FURNISHINGS TO BE REMOVED AND REINSTALLED BY OWNER
 NEW RUBBER FLOORING AREAS (U.N.O.)	4 EXISTING VINYL FLOOR TILE IN STAFF WORKROOM TO REMAIN. (INSTALL NEW RUBBER FLOORING OVER EXISTING)
 NEW RUBBER TILED FLOOR AREAS	
GENERAL NOTES	
1. AREA OF CARPET REMOVAL = 5,290 sq ft	
2. AREA OF NEW CARPET = 4,500 sq ft	
3. AREA OF NEW RUBBER FLOORING = 1,148 sq ft	
4. AREA OF NEW RUBBER FLR TILE = 79 sq ft	
5. RUBBER BASE REPLACEMENT = 225 lin ft	
6. BIDDERS SHALL FIELD-VERIFY ALL DIMENSIONS.	



A1 RECARPETING FLOOR PLAN - SELMA BRANCH LIBRARY

SCALE: 3/32" = 1' - 0"

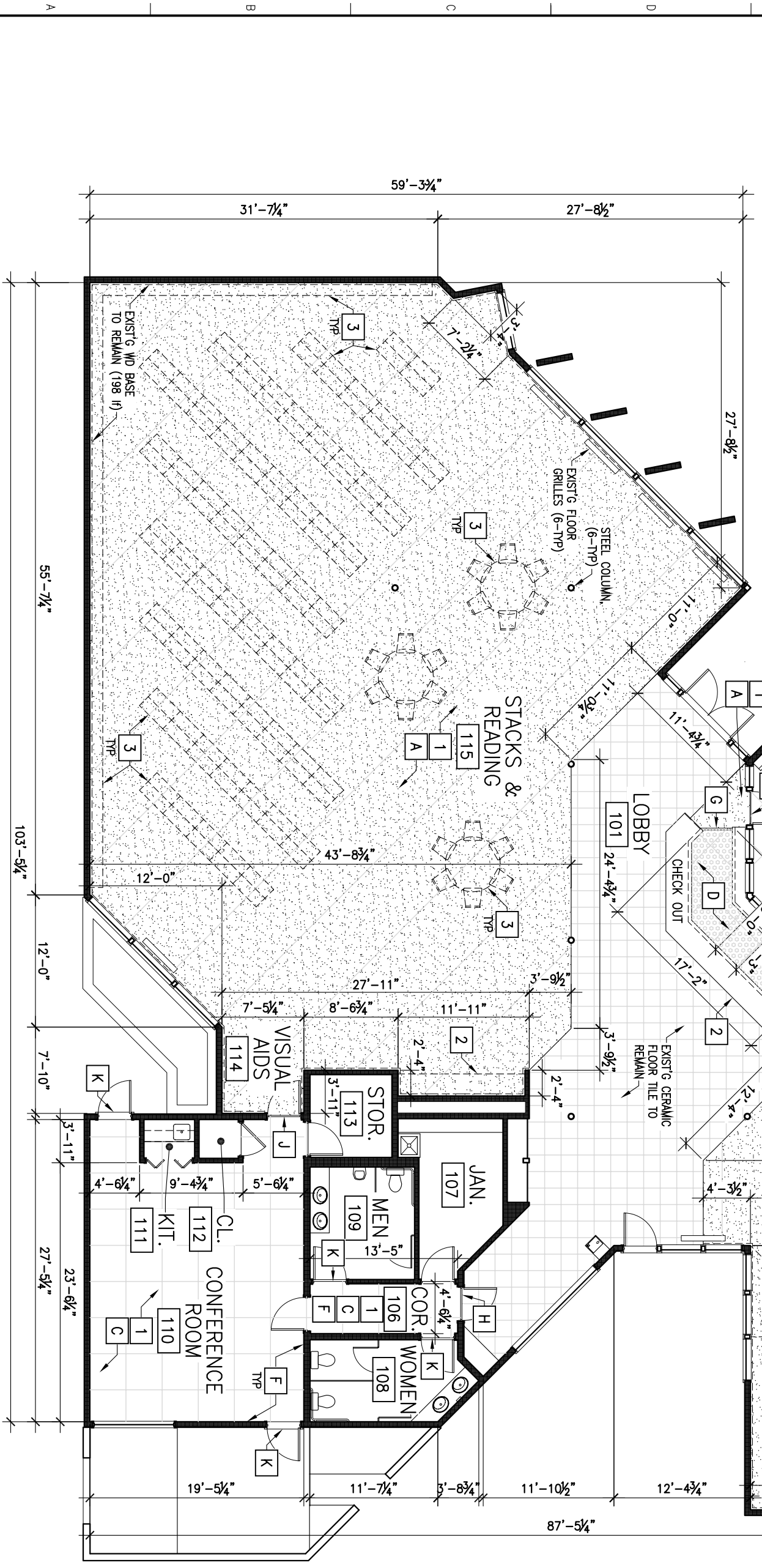
NEW INSTALLATION MATERIALS:

- A** NEW CARPET:
C&A FLOOR COVERINGS
STYLE: XCELERATE POTPOURRI SERIES
COLOR: SONAR/TITEN - 74016X
WITH MARK1-RS BACKING
(FROM QUICK-SHIP PROGRAM)
6 FOOT WIDE ROLL
- B** (NOT USED-THIS SHIT)
- C** NEW RUBBER FLOORING:
NORA RUBBER FLOORING:
NORMANT 925 GRANO SERIES
COLOR: 2090 STARLIGHT
SIZE: 39.37" x 39.37" x3.5mm THK
- D** NEW SPORTS RUBBER FLOOR TILE:
DINOFLEX SPORT MAT FLOORING:
COLOR: 50% BLUE, #6520
SIZE: 38" x 38" x 1/2" SQUARE CUT
- E** NEW RUBBER BASE - TYPE 1:
(NOT USED - THIS SHEET)
- F** NEW RUBBER BASE - TYPE 2:
BURKE MERCER 4" TOP SET COVE BASE
STYLE: COMMERCIAL
COLOR: 303P TAHOE
- G** NEW FLAT VINYL SADDLE
(COLOR TO BE SELECTED)
- H** NEW VINYL TRANSITION STRIP
(COLOR TO BE SELECTED)
- J** NEW METAL CARPET EDGE TRIM
- K** REMOVE & REPLACE EXISTING MTL THRESHOLD



DEPARTMENT OF
PUBLIC WORKS
AND PLANNING

CAPITAL PROJECTS DIVISION
2220 Tulare St. Suite 720, Fresno, California 93721
Phone: (559) 262-4078 Fax: (559) 262-4879

PROJECT:
BRANCH LIBRARIES -
RECARPETING/REPAINTING -
SELMA BRANCH
2200 Selma Street
Selma, CA 93662

SHEET CONTENT:
RECARPETING FLOOR PLAN

DRAWN BY:	RWW	CHECKED BY:	
ISSUE DATE:	12-13-06	CONTRACT NO:	2006-S-XX
ARCHIVE NAME:	Bigg08x-LibraryMontrProjects\A1-RecarpetingProjects\806-A10.dwg		
SHEET NUMBER:			